

Hero Interior Component

This document will explain how to use the “Hero Interior Component”.

1. Click the “Edit” button at the top right of the screen. (screenshot below)

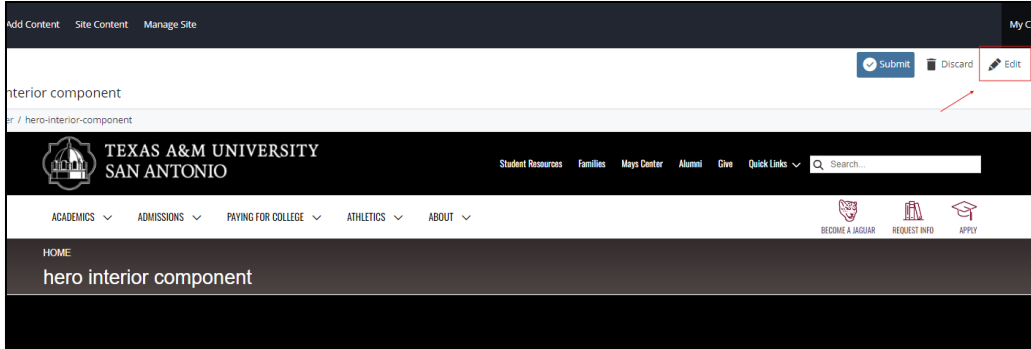

2. Navigate to “Page Builder” section, under “Show in submenu?”. (screenshot below)

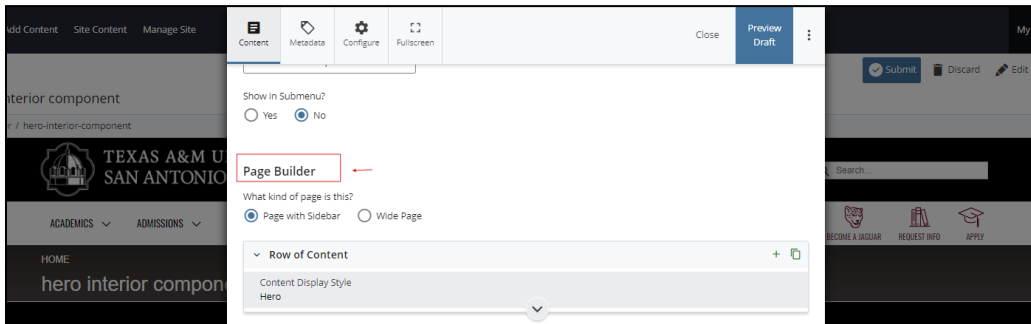

3. Open the “Row of Content” block by clicking the arrow to the left of the “Row of Content” title. (screenshot below)

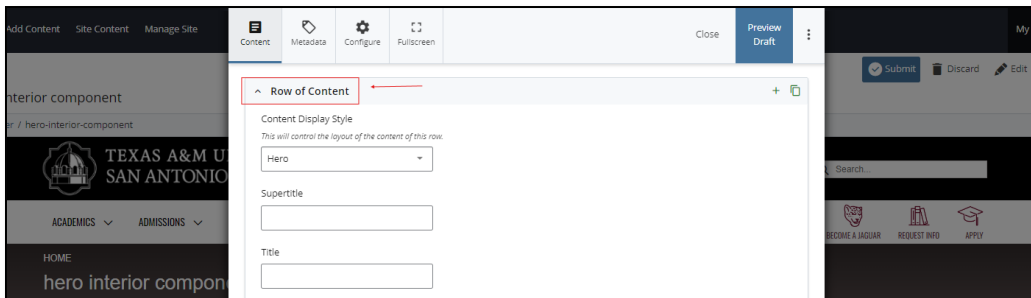

(Next Page)

4. Open the **“Content Display Style”** dropdown menu and select the **“Hero Interior”** option. (screenshot below)

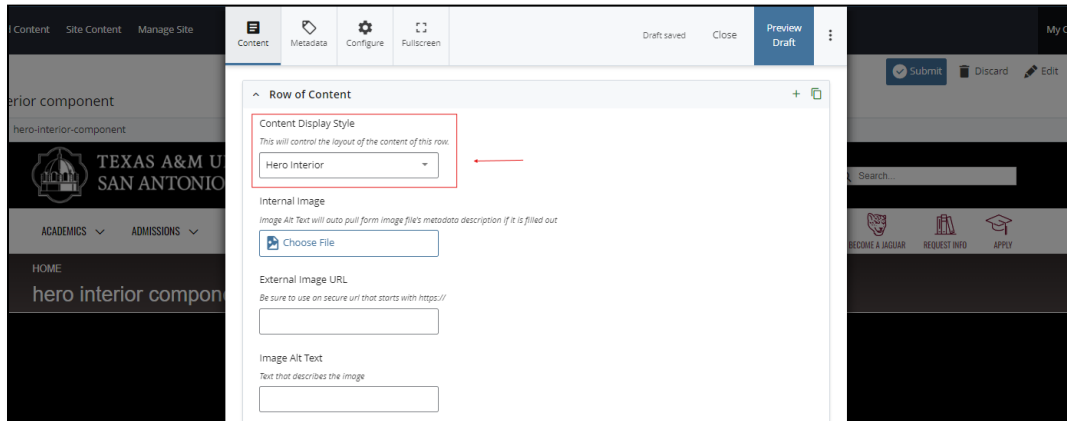

5. Scroll down to **“Internal Image”**. (If you *did not* upload your image into Cascade please move on to “6”) Click on the **“Choose File”** entry and choose the image you would like to add. Finally, ensure the internal image contains **“Alt Text”**. (screenshot below)
- a. Please ensure any images uploaded into Cascade are within an **“Image”** folder.
 - b. Adding internal images is optional.

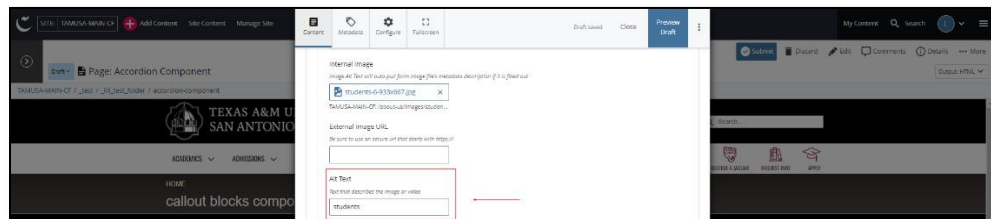
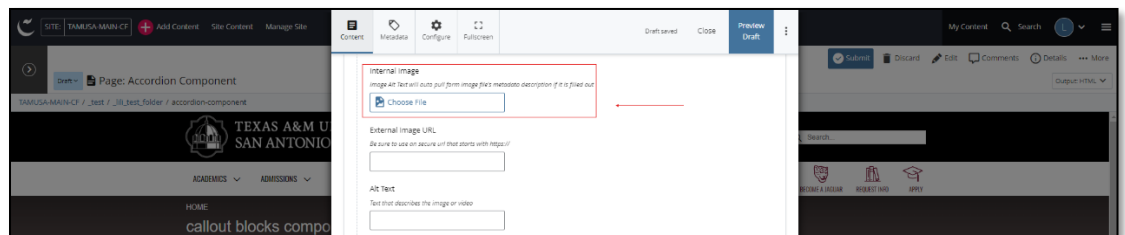

(Next Page)

6. Click on the **“External Image”** entry and enter the URL image address. Finally, ensure the external image contains **“Alt Text”**. (screenshot below)
- a. *Adding external images is optional.*

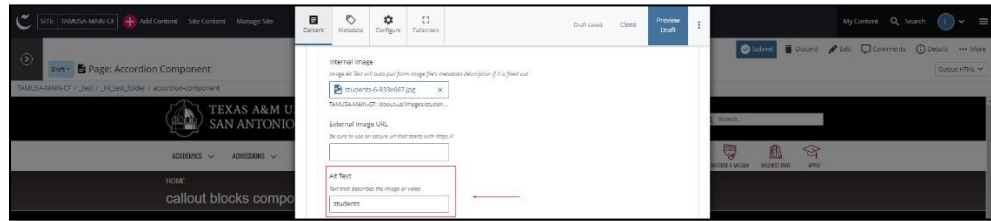

7. After making edits, click on the blue **“Preview Draft”** button at the top right corner. (screenshot below)

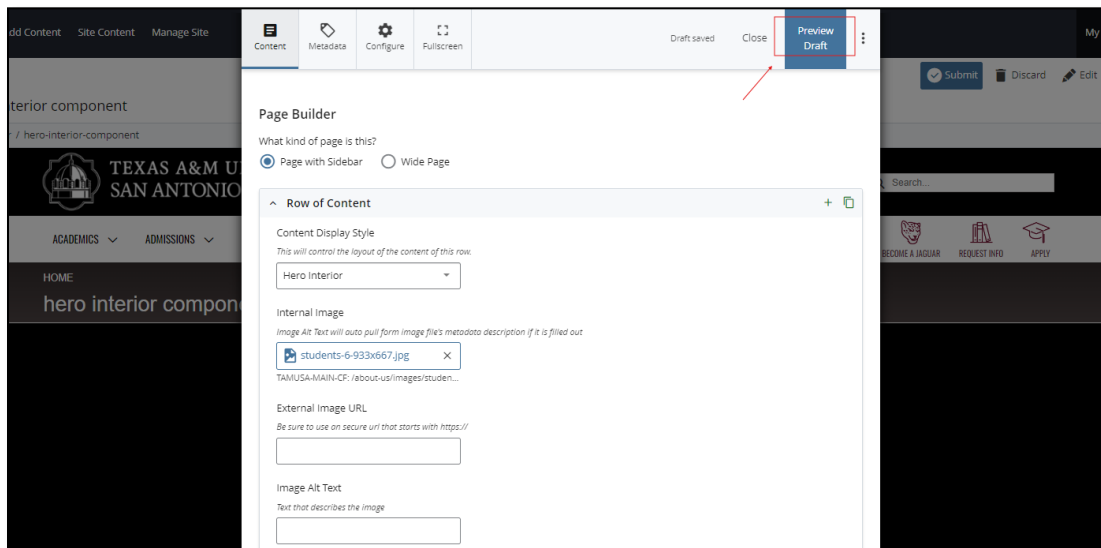

(Next Page)

8. Once you are satisfied, click on the blue **“Submit”**, otherwise click on the **“Edit”** button if you’d like to continue to make changes. (screenshot below)

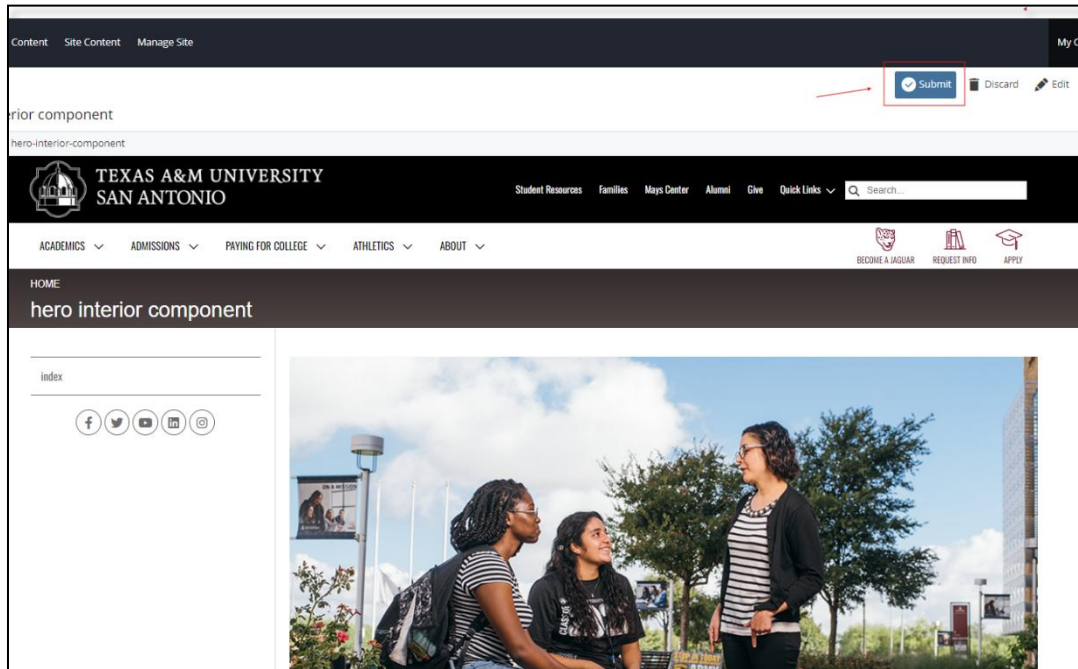

(Next Page)

Practical Applications for Hero Interior

The hero interior component is ideal for showcasing engaging, high-quality imagery that represents a university's culture, diversity, and values. It can be used to highlight key aspects of campus life, such as student interactions, campus events, or notable landmarks, creating a visually appealing introduction to specific sections of the university's website. This component can effectively capture the attention of prospective students and visitors, emphasizing the institution's vibrant and inclusive community. Below is a list of examples we can use the hero interior for.

- Highlighting Major Campus Events
- Featuring Prominent Academic Programs
- Promoting Study Abroad Opportunities
- Showcasing Campus Infrastructure and Landmarks
- Celebrating Diversity and Inclusion Initiatives